

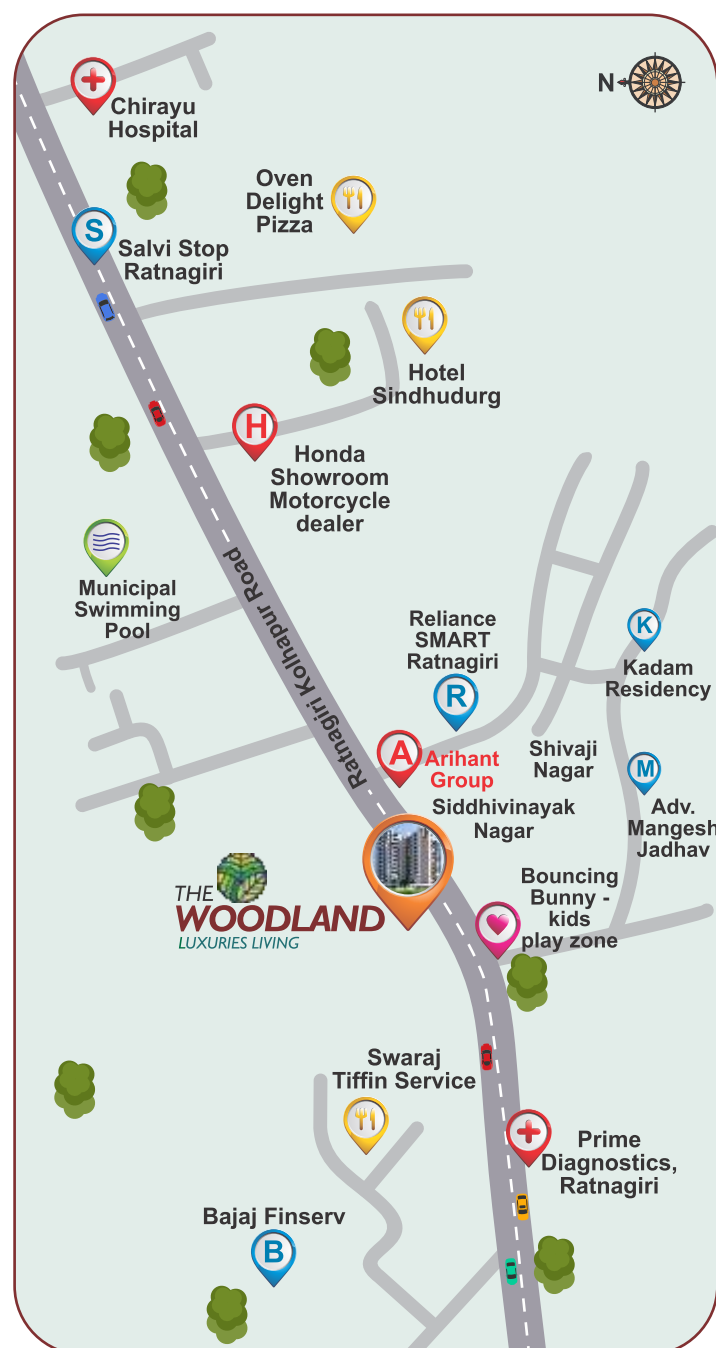

THE WOODLAND
 LUXURIES LIVING

Site: Ratnagiri-Kolhapur Highway, Shivaji Nagar,
 Ratnagiri - 415612

Location Map



ARIHANT GROUP
 For Booking
 9011086861 to 7, 9325903003

: CREDITS :
 Architects : **Milind Yadav**
 Tel. No. 9422436536
 RCC Consultant : **Manoj Joshi**
 Tel No. 9422431064

Siddhivinayak Realty

Office : 1st Floor, Siddhivinayak Community Centre, Siddhivinayak Nagar, Shivaji Nagar,
 Ratnagiri - 415612 Tel. No. (02352) 223052, 223952, 9011086861 to 7

The contents of this brochure are purely conceptual & have no legal binding on us.
 Developers reserve the right to amend the layout, plans, number of floors, elevation, colours schemes, specification & other amenities.

THE WOODLAND
 LUXURIES LIVING

Select a home...
 Elevate your lifestyle!



CONVENIENCE

COMFORT

CARE

ENRICHMENT



ARIHANT GROUP A Project by Aриhant Group
 Making History since 1993

SIDDHIVINAYAK REALTY

(Powered by Arihant Group)

Arihant group is a familiar name for people of Ratnagiri in the Construction business since 1993. Excellent project planning, impeccable construction and timely possession are the solid foundations on which Arihant group is standing proudly. It will not be exaggerated to say that Siddhivinayak Realty project is as sure as Ratnagiri Hapus Mango. Mature teamwork, Expert Engineers, Innovative Architect, Skillful Employees are behind their success. Experienced residents, thousands of satisfied customers and more than 5 lakh Sq.ft. Construction in Ratnagiri, Rajasthan, Jaigad, Chiplun and nearby areas are the testimony of the success.

OUR ONGOING PROJECTS...



Tara Heights,
Mahesh Constructions



Arihant The Park, Ratnagiri
Dream Homes Pvt. Ltd.



Arihant Aurika
Rashi Developers



Arihant Prime
Arihant Dream Homes Pvt. Ltd.



Arihant Atlantis
Arihant Vastu Nirman Pvt. Ltd.



Siddhivinayak Nagar, Phase III
Siddhivinayak Builders & Developers



CONVENIENCE

It all begins with ease of living

If a home was just for living in an enclosed space, anywhere is good. But we need a home not just for its internal space but also for its surroundings since we step out, move and mix around, and return as a routine.

That is where an address providing a convenient access to all places makes for an ideal location for your home. After all, your home is not for a short stay but a lifetime living for a family.

The Woodland comes with a handpicked location that meets the needs of every member of your family. Yet it steers clear from the crowd and cramped up feeling.

The Woodland:

- Ratnagiri-Kolhapur Highway touch property
- Easy access for schools, marketplace, mall & multiplexes, hospitals in neighbourhood



SPECIFICATIONS



STRUCTURE

- Earthquake resistant R.C.C. structure
- 6' thick external & thick walls
- Sand-faced external plaster & Putty for internal plaster



DOORS

- Decorative main door and internal flush doors
- Granite frames for toilet, bathroom & bedroom



WINDOWS

- Anodised Aluminium sliding windows with mosquito net
- Louver windows in W.C. & bathroom
- Granite window sills



KITCHEN

- Granite platforms with S.S. sink
- Designer tiles
- Water purifier
- One-side loft

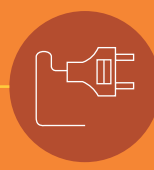

ELECTRIFICATION

- Concealed Copper wiring
- Provision for A/C points in bedroom
- TV & Telephone points in living room
- Modular switches and circuit breaker
- Tube lights & fans in living & bedroom



FLOORING

- Branded 1x1 meter vitrified tiles for entire flat
- 12'X12' tiles for bathrooms
- Antiskid tiles for toilets, flower beds & terrace



TOILETS

- Concealed plumbing work
- Branded sanitary fittings with mixture
- Designer glazed full tiles
- Provisions for Loft tank



PAINTING

- Distemper for internal walls and waterproof acrylic paint on external walls

A nest for all seasons





CARE

It makes a thoughtful statement

A home symbolises care. It is what makes relations and keeps all happy and healthy within the relationship. This is possible only when your home is built with thoughtfulness for each member in the family.

It calls for expert planning of every aspect, from accounting for each block, to filling of every space.

The Woodland offers an abundance of natural luxuries like landscaping, sunlight, fresh air, and many lifestyle amenities for a healthy living.

The Woodland:

- Attractive main gate with security cabin
- Intercom connection to each flat
- CCTV surveillance cameras
- Firefighting system
- Terrace gym
- Children's play area with equipment



9th TO 12th FLOOR PLAN

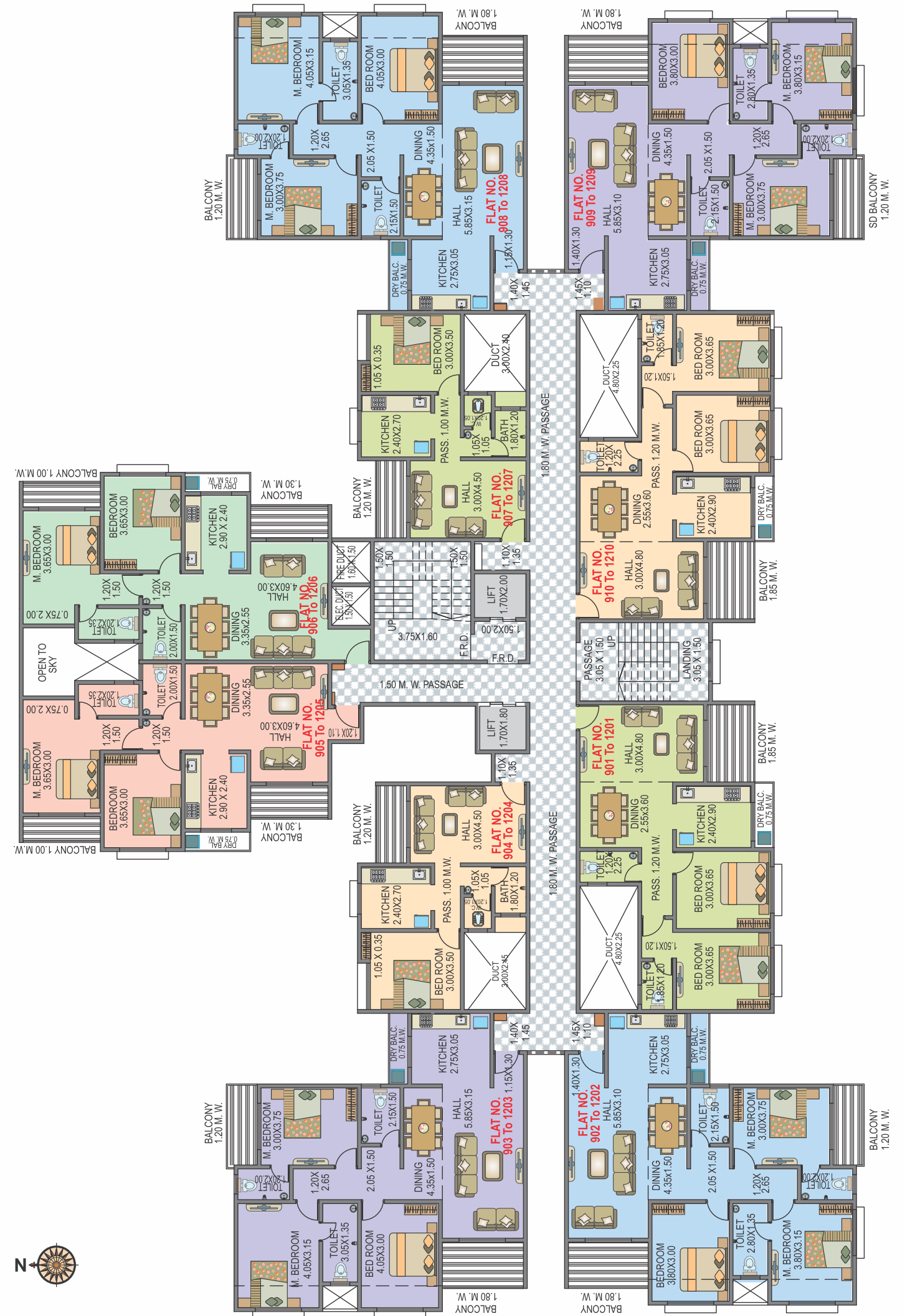

8th FLOOR PLAN

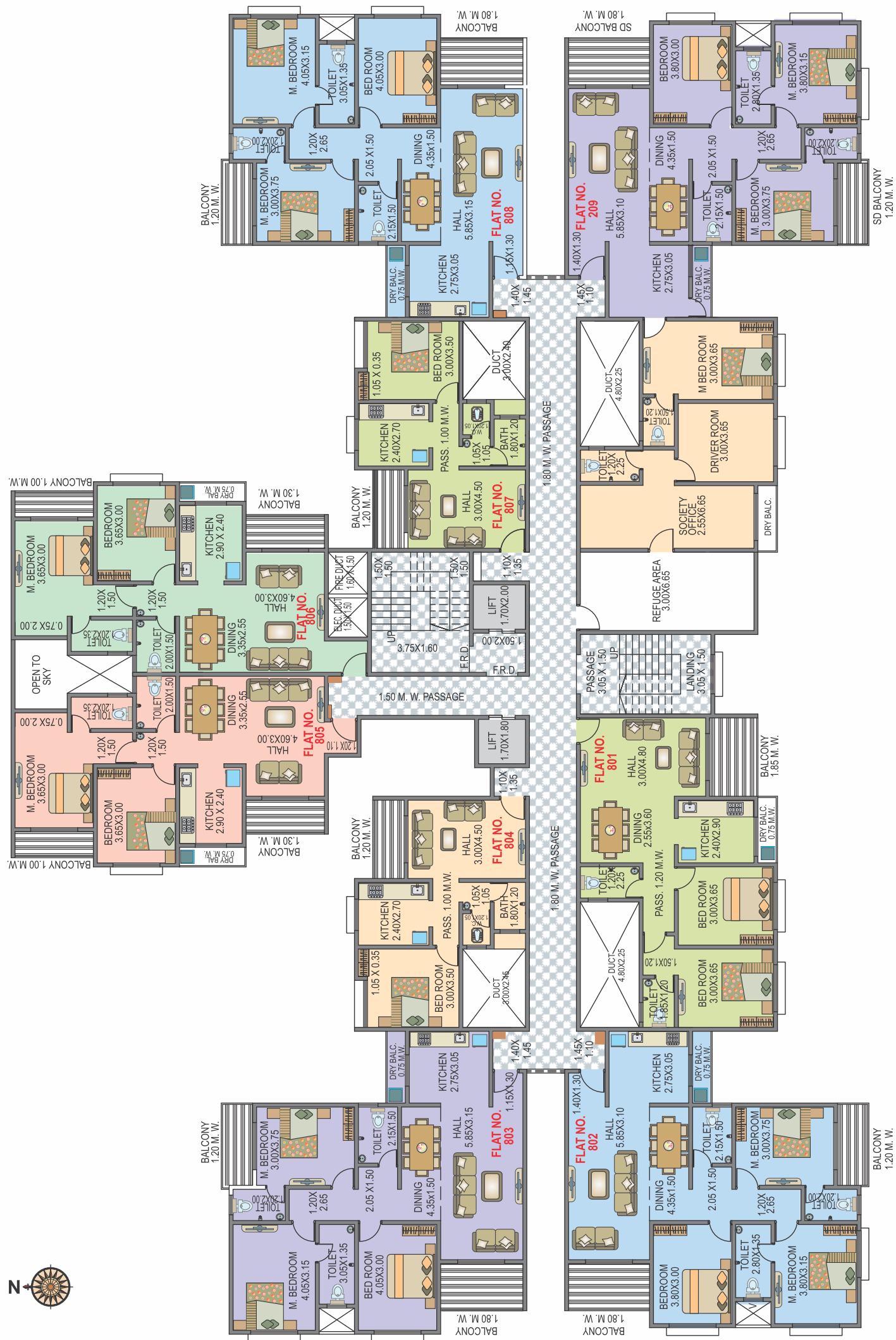

COMFORT

It delights by being generous.

A home should be big enough for the comfort of all. This requires it to be spacious enough without being wasteful. It should allow free movement of the occupants as well as the things between the rooms, inside the home, and within the community.

This comes from our impeccable designing of the interiors and thoughtful layout of the external amenities like roads, parking spaces, and recreational areas.

The Woodland is like a big heart that holds your near and dear ones in an affectionate embrace. It is where everyone feels safe, when inside the home or within the premises.

The Woodland:

- Spread over one acre of verdant land
- Internal paver block roads
- Attractive entrance lobby
- Piped cooking gas





3rd TO 7th FLOOR PLAN

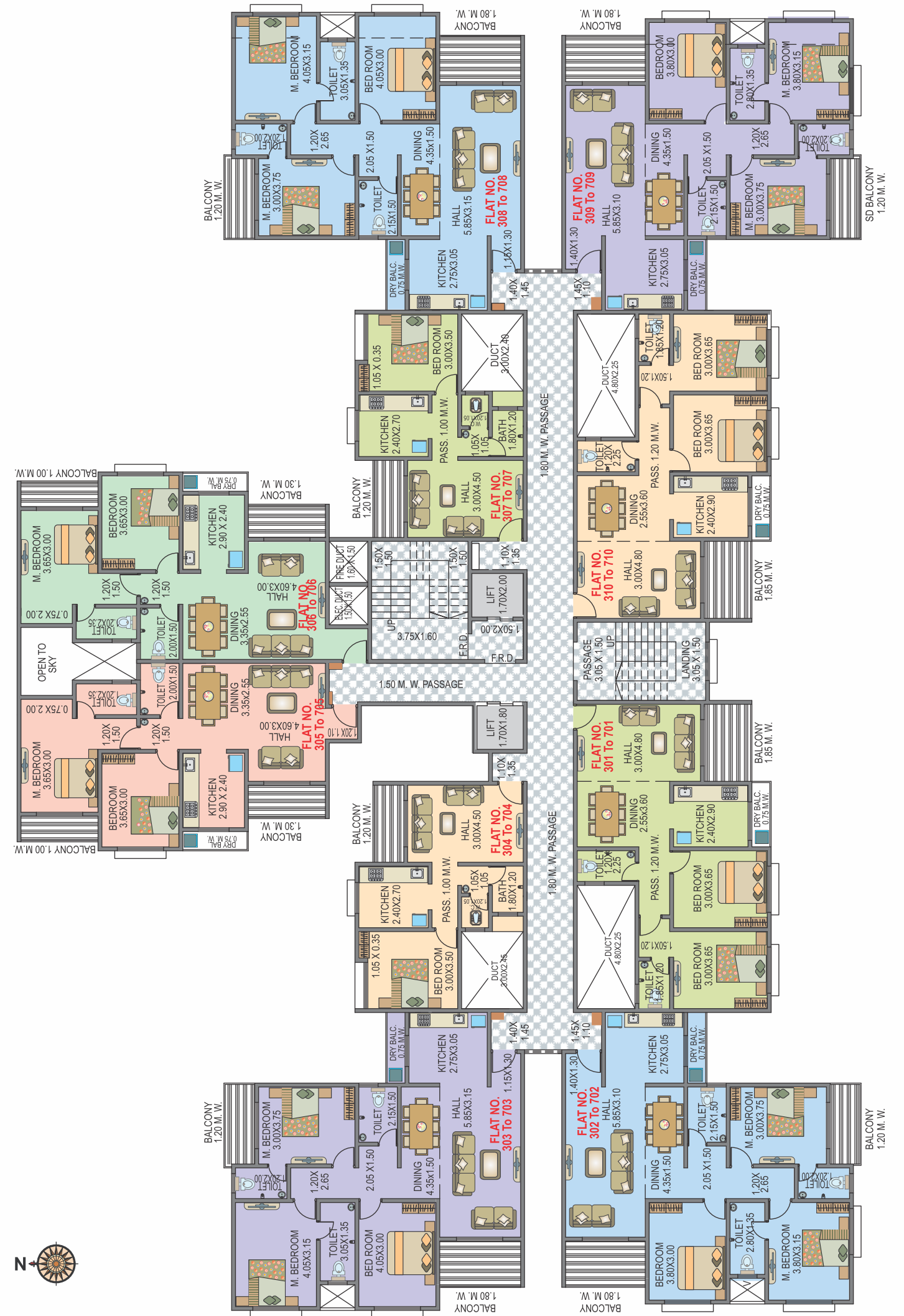

2nd FLOOR PLAN

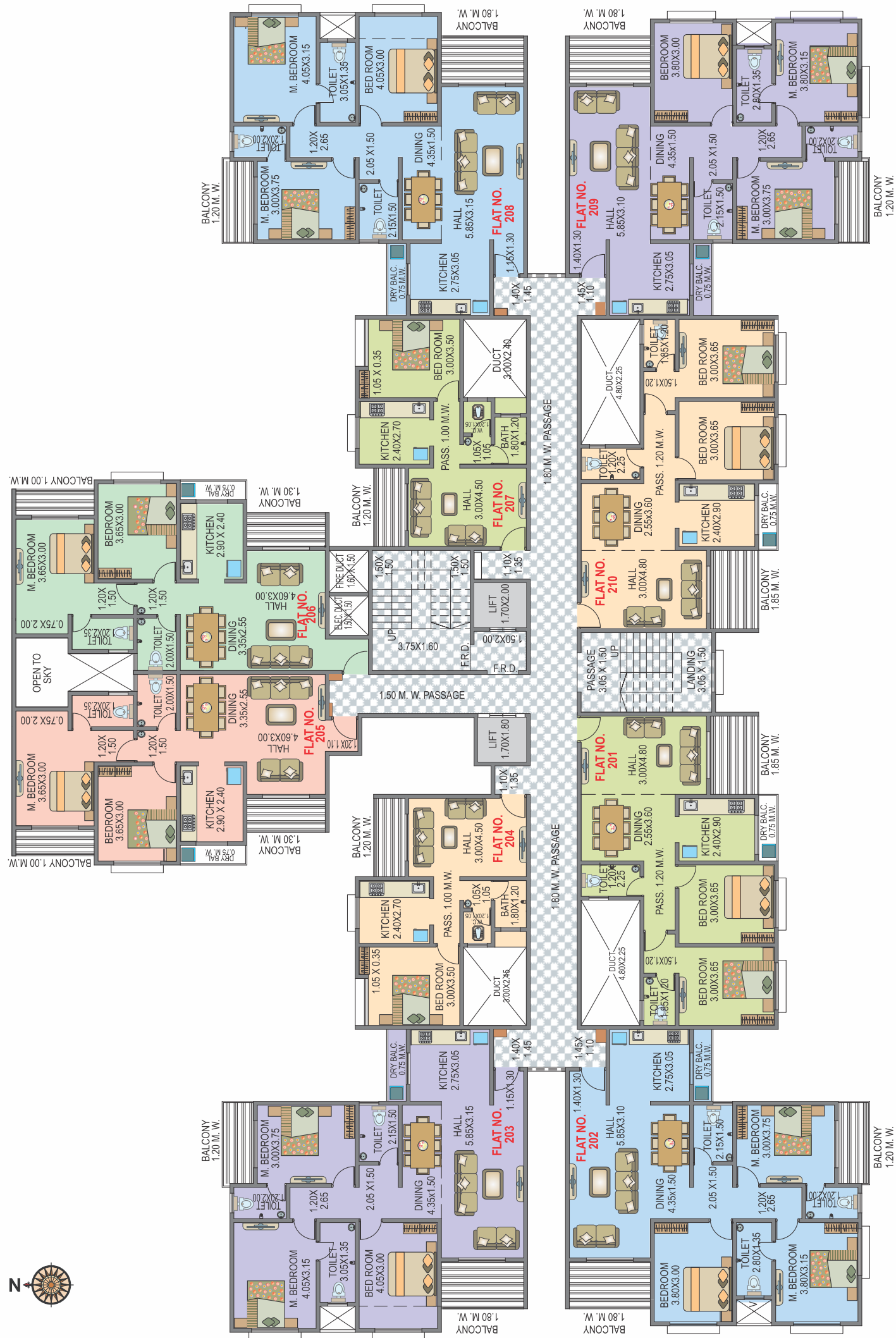



ENRICHMENT

It makes life complete and fulfilling

Life is a story of moments lived over a lifetime. A home enriches each moment making the story worth telling and retelling over generations. It is where you dream and hope to fulfil your aspirations.

This demands a lot of confidence by putting your home on a firm ground and then raising it skywards.

The Woodland is a high-rise with an attractive façade and a pleasing persona; a tribute to the city skyline as well as to the life of each homemaker.

The Woodland:

- ISI standard lifts with power backup
- WIFI connectivity
- Rainwater harvesting
- Tree plantation



1st FLOOR PLAN

